



Artists Impression  
Accessories and Pergola not included

# Haven Kitset

60m<sup>2</sup>

 2 Bedrooms  
  1 Living area  
  1 Bathrooms

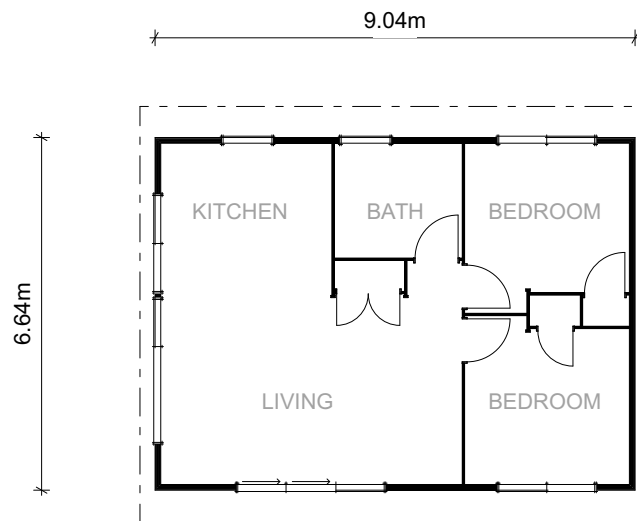

The Haven is a modern compact plan with two bedrooms, one bathroom, and open plan living. Designed to fit within most council requirements, this small home is perfect for a second dwelling or getaway pad. The mono-pitch roofline and high, sarked, timber ceilings with large sliding doors offer a great sense of space and light.

Talk to the Kitset team about a Haven for your site today!



Phone 0508 562 596 | Email [info@lockwood.co.nz](mailto:info@lockwood.co.nz)  
[lockwoodreadybuilt.co.nz/kitset](http://lockwoodreadybuilt.co.nz/kitset)





# Haven Kitset

60m<sup>2</sup>

 2 Bedrooms  1 Living area  1 Bathrooms Laundry

## Inclusions

- Insulated exterior walls
- Thermally broken windows and doors
- Interior Walls, doors, wardrobes and cupboards
- Suspended timber subfloor
- Roof framing timbers
- Sarked timber ceilings
- Full building plans for site-specific consent
- Allowance for preparation site-specific consents

## Exclusions

When you order a kitset from Lockwood, there are a number of items that aren't included in the advertised price. These include but are not limited to:

- Any building processes required to construct the home
- Kitchen, bathroom and laundry fixtures
- Drapes and floor coverings
- Under floor and roof insulation
- Sealants/glues, floor nails / product nails, screws
- Electrical fixtures, electrical wiring
- Plumbing fixtures and fittings
- Roofing, gutters and downpipes
- Wet wall linings (Acrylic / Tiles to Bath/Shower and associated finishing materials)
- Site work materials (including concrete, reinforcing, service connections, house piles and bearer kits)
- BCA fees for site consents
- Site specific engineering where required for consent
- Freight

Talk to us for a full list of inclusions and exclusions.

Talk to the Kitset team about a Haven for your site today!

Phone 0508 562 596 | Email [info@lockwood.co.nz](mailto:info@lockwood.co.nz)  
[lockwoodreadybuilt.co.nz/kitset](http://lockwoodreadybuilt.co.nz/kitset)

