

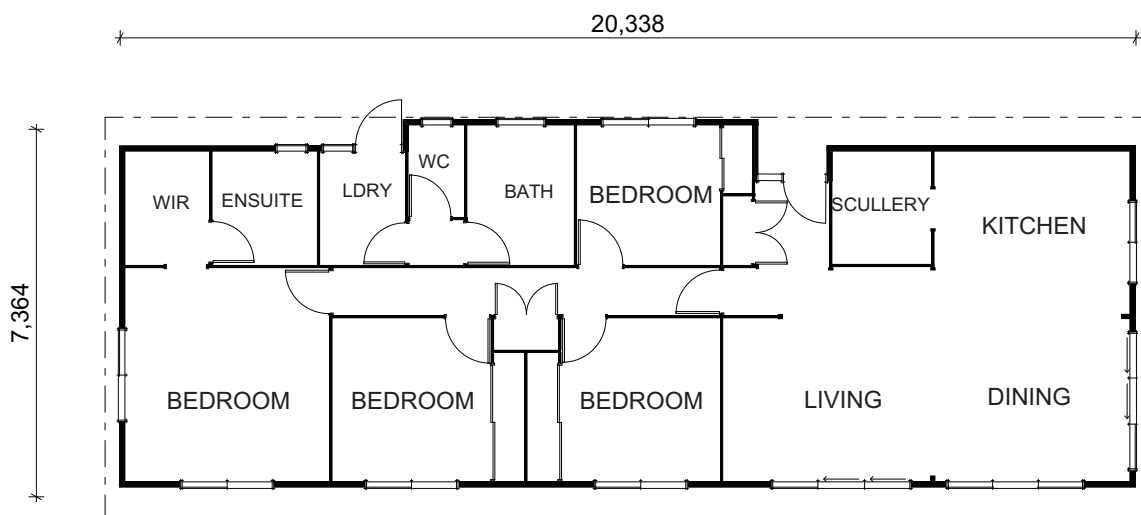

Riverview Monopitch 142m²

 4 Bedrooms
  1 Living area
  2 Bathrooms
 Walk in Pantry Large WIR Separate Laundry



The four bedroom Riverview packs a whole lot into a 142m² footprint, including generous bedrooms, two bathrooms, scullery and walk-in-wardrobe. The bedrooms in the Riverview are at one end of the home, separating the living and sleeping areas for ultimate peace and quiet. The monopitch roofline is a modern design and offer loads of light into the living and kitchen space.

This design is also available as a trussed design with flat ceilings. Talk to us about the various options for a ReadyBuilt home on your site.

Talk to the ReadyBuilt team about a Riverview for your site today!
 Phone 0508 562 596 | Email info@lockwood.co.nz
www.lockwoodreadybuilt.co.nz

ReadyBuilt
 by  LOCKWOOD



Riverview Monopitch 142m²

 4 Bedrooms

 1 Living area

 2 Bathrooms

Separate Laundry

Large WIR

ReadyBuilt homes include

- Kitchen cabinetry
- Bathroom fittings plumbed to floor
- Smeg appliances including cooktop, oven, rangehood & dishwasher
- Pre consent plans (required for site specific consent)
- Double glazed thermally broken windows and doors
- Ceiling, wall and underfloor insulation
- LED lighting
- High quality fitted carpet and vinyl
- Internal and external painting and finishing

Exclusions

Decking, window coverings, site works, service connections and local authority consents, hot water heating, and transport are not included in the pricing for your ReadyBuilt home.

Although these items are excluded from standard supply, they can be quoted and supplied on request. We are also able to assist in obtaining site consents and engineering if required.

Contact us for a full list of specifications and how we can assist.

Pricing includes GST and is valid for the North Island only until 1/03/2025 and is subject to change

Talk to the ReadyBuilt team about a Riverview for your site today!

Phone 0508 562 596 | Email info@lockwood.co.nz

www.lockwoodreadybuilt.co.nz

ReadyBuilt
by  **LOCKWOOD**